

## Apartment in Marbella

**2,450,000 €**

**Reference:** WIN-643   **Bedrooms:** 4   **Bathrooms:** 2   **Plot Size:** 454m<sup>2</sup>   **Build Size:** 454m<sup>2</sup>

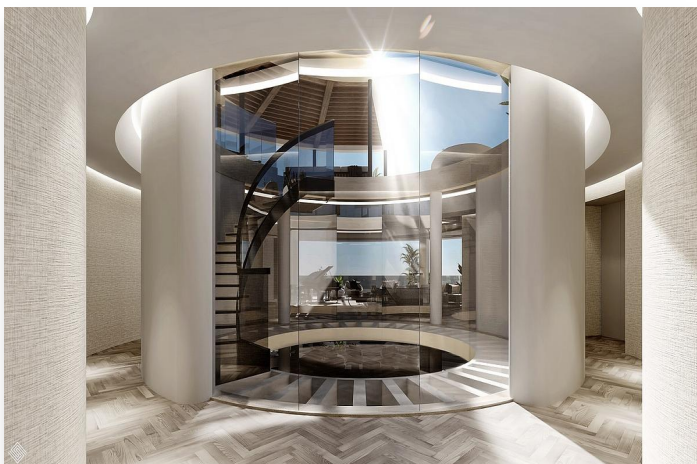



## Location: Marbella

The project is conveniently located between Marbella and Benahavís within quick and easy reach of the beaches and town centres. The buildings of the development are beautifully integrated within their natural surroundings. The combination of luxurious, contemporary properties fused with the stunning backdrop of the Sierra Blanca Mountains is one of the many reasons why Marbella proves to be so popular with many people. Modern architecture and stunning state of the art building techniques are utilised to ensure you are getting the quality of living you desire. We provide 2, 3 or 4 bedroom apartments with various floorplans, allowing us to find a home that meets your lifestyle needs. We also offer an exclusive collection of apartments that are singular for their size as well as their design. For more information or to arrange a viewing contact us today. Features Sea Views Security Pool Many other extras

## Features:

### Views

Sea View

### Features

New Build