

Penthouse in Benalmádena

995,000 €

Reference: BOHOMES1054 **Bedrooms:** 3 **Bathrooms:** 2 **Build Size:** 211m² **Terrace:** 55m²

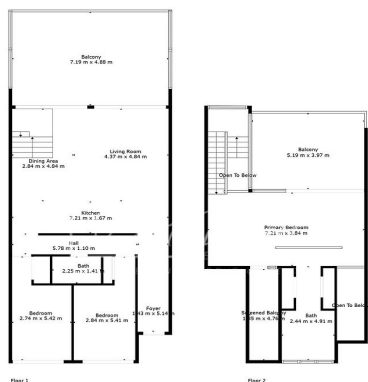

TOTAL: 139 m²
FLOOR 1: 92 m², FLOOR 2: 47 m²
 EXCLUDED AREAS: BALCONY: 50 m², SCREENED BALCONY: 6 m², OPEN TO BELOW: 7 m²
 Floor Plan Created By: Colocale App. Measurements Donated. Rights Reserved. Not Not Guaranteed.



Location: Benalmádena

Nestled in the exclusive Stupa Hills of Benalmadena, this newly built penthouse offers an unparalleled living experience with breathtaking panoramic views of the Mediterranean Sea, the surrounding hills, and the iconic Stupa of Enlightenment. Spanning over 200 square meters of luxurious space, the penthouse boasts an open-plan design, flooded with natural light, and finished to the highest standards.

The spacious living area seamlessly blends modern elegance with comfort, featuring large floor-to-ceiling windows that open onto expansive terrace perfect for outdoor dining or simply relaxing while enjoying the stunning views. The contemporary kitchen is a chef's dream, equipped with top-of-the-line appliances, sleek countertops, and ample storage.

The penthouse offers three generously sized bedrooms, including a master suite with its own private terrace, walk-in closet, en-suite bathroom, rain shower, and dual vanities. The two additional bedrooms are located on the entry level and share a beautifully designed bathroom.

Additional features include water based underfloor heating in every room, integrated air conditioning, and home automation system. The property also benefits from private parking, a communal infinity pool, lush gardens, and a fully equipped gym, making it a perfect blend of luxury and convenience.

Located just minutes from the charming town of Benalmadena and its vibrant beaches, restaurants, and cultural attractions, this penthouse offers the ultimate in coastal living, where every detail has been carefully curated to provide an exceptional lifestyle in one of the most sought-after areas of the Costa del Sol.

Features:

Setting

Close To Sea

Features

Covered Terrace

Lift

Private Terrace

Double Glazing

Gym

Sauna

Fitted Wardrobes

close to schools

Telephone

Close to Shops

Close to Golf

Balcony

alarm

Close to Town

Heated Pool

INDOOR POOL

Fully Fitted Kitchen

Armored Door

Panoramic view

Handicap Accessible

Spa

Gated Community

Excellent Condition

Close to Port

Surveillance Cameras

close to restaurants

Close to children playground

Mountainside

Amenities near

Underfloor heating (throughout)

Brand new

Home automation system

Uncovered terrace

Porcelain floors

Glass Doors

Transport near

Video entrance

Internet - Fibre optic

EV charging station

Internet - Wi-Fi

Reverse Osmosis water system

Climate Control

Air Conditioning

Views

Sea View